

RECEIVED

AUG 23 2010

Division of Minerals

STATE OF NEVADA
COMMISSION ON MINERAL RESOURCES
DIVISION OF MINERALS
400 W. King Street, Suite 106
Carson City, Nevada 89703
(775) 684-7040 ! Fax (775) 684-7052

Date Received	_____
API Number	<u>N/A</u>
County	<u>Storey</u>
Project Area	<u>1171</u>
Permit Number	<u>1171</u>
FOR DIVISION USE ONLY	

GEOTHERMAL PROJECT AREA PERMIT APPLICATION

Name or Corporate/Business Name

NGP (Pumpnickel I)

Street Address 595 Double Eagle Court, Suite 2001,

City Reno State NV Zip Code 89521

Telephone 775-786-3399

hereby makes application for a geothermal development permit, State of Nevada, Division of Minerals.

(If applicant is a corporation, show state and date of incorporation; if a partnership, list names of partners.)

NGP Pumpnickel I was incorporated November 6, 2009

This application is for 8 production wells

Estimated total depth of production wells: 6,000 ft

9 injection wells

Estimated total depth of injection wells: 6,000 ft

3 observation wells

Estimated total depth of observation wells: 6,000 ft

Purpose of Wells:

Exploration drilling, and reservoir confirmation and characterization.

Project Area or Unit Name: Pumpnickel Valley

Description of Project Area by Section, Township, and Range (a map of the project area must be included with the application):

T34N R40E: Sections 33, 34; T33N R40E: Sections 3, 4, 8, 9, 10 (see attached map)

Applicant is: Land Owner Lease Holder

Land Owner Name: _____

Geothermal Resource Owner Name: NGP (Pumpnickel I)

Operator's Name: NGP (Pumpnickel I)
Address: 595 Double Eagle Court, Suite 2001
City, St Zip: Reno, NV, 89521

Drilling Contractor's Name: To be determined
Address: _____
City, St Zip: _____
Telephone: _____

Drilling Program - attach sample drilling program(s) which must include rotary rig description, casing program, and equipment for the prevention of a blowout.

Planned Use of Geothermal Resource:

If a commercial reservoir is confirmed, the wells will be used to generate power in a geothermal power plant.

Planned Disposal of Spent Geothermal Fluid:

All spent geothermal fluid will be contained in a reserve pit adjacent to the well.

Bond Type:	BLM Bond	State Bond
Bond Amount:		\$50,000
Bond Number:		N-58196 NVB000504
Issued By Name (bank, surety, etc.):		Bank of the West
Issued By CD Number or Account Number:		004-000-718817

The Source of the Proposed Geothermal Resource is: Meta-Sediments of Triassic Age.
(List name of hot spring, geologic formation(s) or other source.)

Drilling will Begin On or Before: 1 October 2010

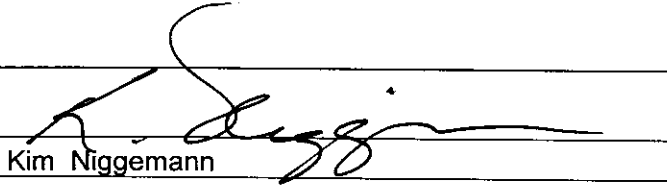
Signature of Applicant/Agent: 
Printed Name of Applicant/Agent: Kim Niggemann
Date: 20 August 2010

***** Please enclose the \$500.00 fee along with this application*****

PERMIT APPROVAL

Approved 9/1/10 with the conditions attached and made a part of the permit.
Date

Project Area Permit Number 1171

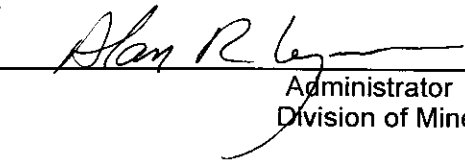

Administrator
Division of Minerals

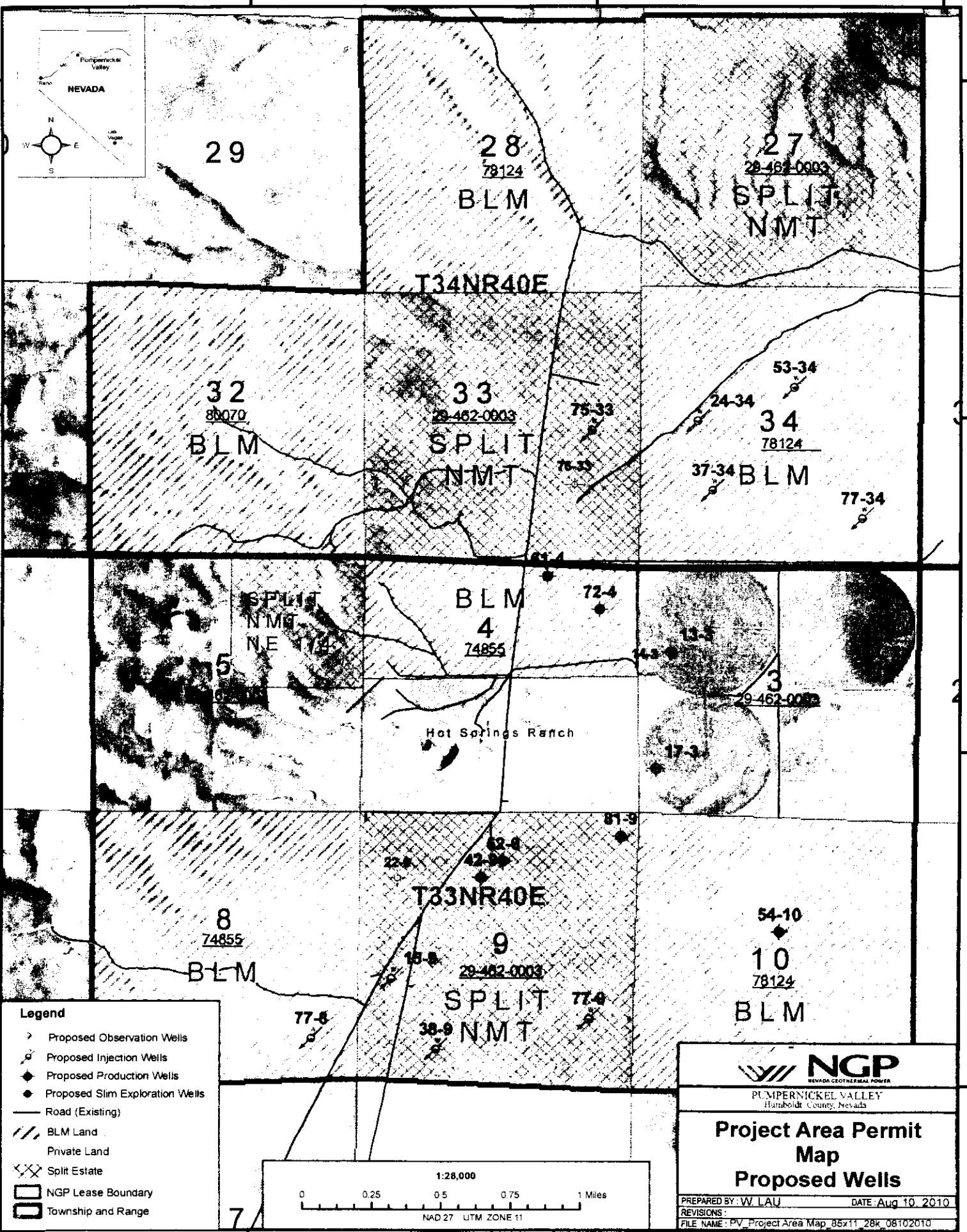
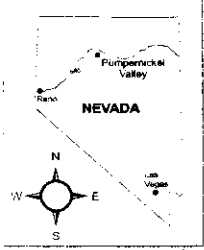
PV Project Area 2010 Proposed Well List							
PV Proposed Wells	Type	T/R	Section	Quarter/Quarter	Easting	Northing	REMARK
72-4 (BLM)	Production	33N/40E	4	NE/NE	460021.33mE	4512841.93mN	
77-8 (BLM)	Injection	33N/40E	8	SE/SE	458364.71mE	4510272.84mN	
38-9 (Split)	Injection	33N/40E	9	SE/SW	459091.14mE	4510210.83mN	Federal Surface
42-9 (Split)	Production	33N/40E	9	NE/NW	459343.69mE	4511236.81mN	Federal Surface
52-9 (Split)	Slim	33N/40E	9	NW/NE	459468.89mE	4511336.85mN	Federal Surface
75-33 (Split)	Injection	34N/40E	33	NE/SE	459974.71mE	4513914.76mN	Federal Surface
37-34 (BLM)	Injection	34N/40E	34	SE/SW	460674.71mE	4513558.02mN	
77-34 (BLM)	Injection	34N/40E	34	SE/SE	461536.26mE	4513396.48mN	
61-4 (BLM)	Slim	33N/40E	4	NW/NE	459718.93mE	4513039.75mN	
77-9 (Split)	Injection	33N/40E	9	NE/SE	459975.51mE	4510395.79mN	Federal Surface
54-10 (BLM)	Slim	33N/40E	10	SW/NE	461072.96mE	4510919.85mN	
53-34 (BLM)	Injection	34N/40E	34	SW/NE	461140.78mE	4514175.21mN	
81-9 (Split)	Production	33N/40E	9	NE/NE	460154.31mE	4511487.07mN	Federal Surface
17-3	Production	33N/40E	3	SW/SW	460356.053mE	4511893.72mN	
13-3	Production	33N/40E	3	SW/NW	460437.032mE	4512589.83mN	
15-9 (Split)	Injection	33N/40E	9	NW/SW	458829.689mE	4510629.3mN	Federal Surface
24-34 (BLM)	Injection	33N/40E	34	SW/NW	460588.396mE	4513973.73mN	
22-9 (Split)	Observation	33N/40E	9	NW/NW	458857.946mE	4511229.01mN	Federal Surface
14-3	Observation	33N/40E	3	SW/NW	460285.185mE	4512461.68mN	
76-33 (Split)	Observation	34N/40E	33	NE/SE	459871.732mE	4513585.56mN	Federal Surface

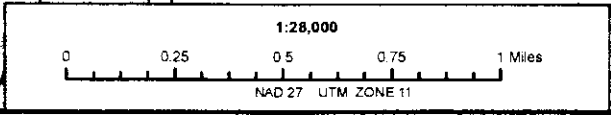

Legend

- > Proposed Observation Wells
- Proposed Injection Wells
- ◆ Proposed Production Wells
- Proposed Slim Exploration Wells
- Road (Existing)
- /// BLM Land
- Private Land
- XX Split Estate
- NGP Lease Boundary
- Township and Range



NGP
NEVADA GEOTHERMAL POWER

PUMPHNICKEL VALLEY
Humboldt County, Nevada

**Project Area Permit
Map
Proposed Wells**

PREPARED BY: W. LAU DATE: Aug 10, 2010
 REVISIONS:
 FILE NAME: PV_Project Area Map_85x11_28k_08102010

436000
437000
438000
439000
440000

462000
463000
464000
465000
466000